



**CONSOLIS**



## COMPACT CULVERTS

This range of value for money, rectangular precast concrete culverts is designed to provide a rapid and economical solution when smaller culverts are required.

Can be used for dry networks such as cabling or for effective water management.

A focused range of six sizes (see overleaf) from 500 x 300mm through to 1500 x 700mm in 2.4m lengths complete with a factory fitted integrated gasket to enable simple installation.

### Features:

- Factory fitted integrated gasket joint.
- Cast in lifting anchors for safer offloading.
- Factory standard design typically available within two weeks.
- Rapid installation
- Suitable for low cover levels of up to 3m.
- Manufactured to EN 14844 and in accordance with relevant European standards and CE marked accordingly.

See overleaf for dimensional data >



# Technical Data

Two lifting anchors are cast into each unit to enable safer offloading.

Drawings are available on the website at [www.stanton-bonna.co.uk](http://www.stanton-bonna.co.uk) in Technical Guides.

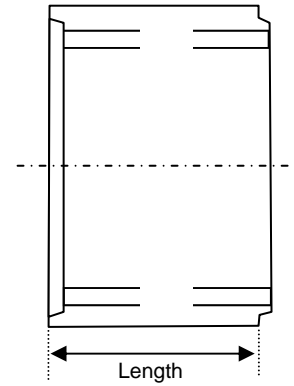
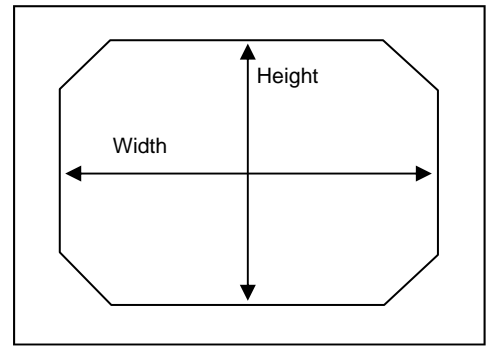

Compact Culvert Dimensions				
W x H (mm)	Length (mm)	Thickness (mm)	Unit Weight (Tonne)	Lifting Anchors
500 x 300	2400	130	1.65	2 x 2.5T
600 x 400	2400	130	1.95	2 x 2.5T
800 x 400	2400	130	2.25	2 x 2.5T
1000 x 400	2400	130	2.63	2 x 5T
1100 x 550	2400	130	3.15	2 x 5T
1500 x 700	2400	130	4.81	2 x 5T

Please note all dimensions and weights are approximate.

Stanton Bonna supply a wide range of culvert options including:

- Box Culverts with integrated gasket.
- AquaCulvert with integrated dry weather flow channel.
- Elliptical Culverts with superior hydraulic performance.

Further details are available on the website.

**Please contact us to discuss your project.**



Box Culverts and AquaCulvert pictured below



## StantonBonna

- T** 0115 944 1448
- F** 0115 944 1466
- E** [info@stanton-bonna.co.uk](mailto:info@stanton-bonna.co.uk)
- W** [www.stanton-bonna.co.uk](http://www.stanton-bonna.co.uk)