

T 0115 944 1448  
 F 0115 944 1466  
 E info@stanton-bonna.co.uk  
 W www.stanton-bonna.co.uk

# Manhole Jointing Compound and Road Gullies

## Manhole Jointing Compound

Manholes are designed and manufactured to provide accurate joint profiles with a high quality finish. When used in conjunction with flexible jointing compound, contractors can construct watertight manholes quickly, without the need for concrete surround. Flexible jointing compound is approved for such applications by the Department of the Environment and the Ministry of Agriculture Fisheries and Food and the use of flexible jointing compound with precast concrete units is strongly urged on engineers in the Reports of the Working Party on the Construction and Design of Underground Pipe Sewers so that the high costs of in-situ concrete surrounds can be avoided.

This method of construction meets the requirements of Building Regulations 1992 Building Standards (Scotland) Regulations 1990, DTp Specification for Highway Works 1994, DoE Working Party on Sewers and Water Mains Report 1975 and is specifically endorsed by Laxton's General Specification 1996, Scottish Association of Directors of Water and Sewerage Services and DoE Northern Ireland Standard Specification for Water and Sewerage Schemes (3rd edition) 1989, and Water Services Association Civil Engineering Specification for the Water Industry (5th edition) 1998.

The use of the precast concrete products with flexible jointing compound also meets the requirements of Water Authorities Association specification Sewers for Adoption (5th edition).

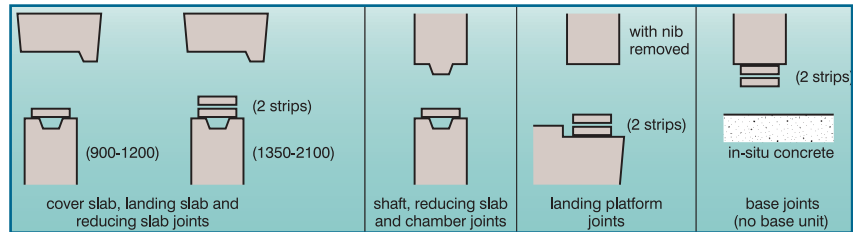

Chamber Ring	DN	900	1050	1200	1350	1500	1800	2100	2400	2700	3000
Jointing Compound	mm	12 x 60		12 x 80				12 x 120			
Metres per carton	m	24		18				12			
Jointing Compound per joint	m	3.5	4.0	4.5	5.0	5.5	6.5	7.5	8.5	9.5	10.5
Joints per carton	No.	6.8	6.0	4	3.6	3.2	2.7	1.6	1.4	1.2	1.1
Primer coverage	m	75		50				35			

## Road Gullies

Kitemarked gullies made to BS 5911: Part 230 are available and can be supplied with adaptors for connection to clay or plastic pipes.

Gully cover slabs are available with a DN 450 access. Slabs are 100mm thick and weigh approximately 80kg.

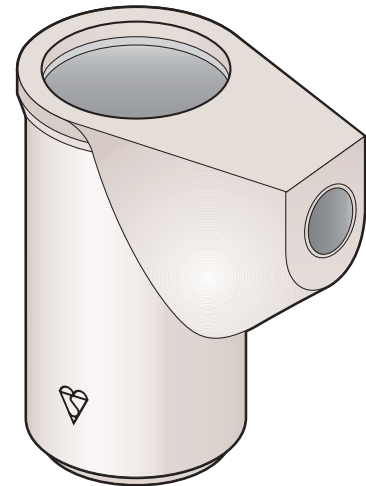
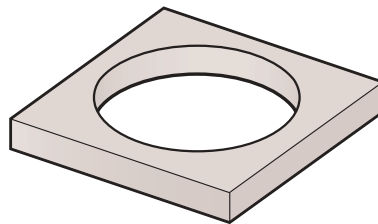

## Road Gullies Data

Nominal Diameter	Nominal Depth	Approx Weight
mm	mm	Kg
375	750	185
375	900	200
450	750	260
450	900	290
450	1050	320